



SNR LUBSOLID STAINLESS STEEL BALL BEARING



SENTINEL food range

The SNR stainless steel deep groove ball bearing with LUBSOLID "Full Pack" filling 100% of the free volume, is highly resistant to the penetration of water and pollution for maximum longevity.

Description

100% stainless steel bearing

- Rings
- Rolling elements
- Cage

SNR LUBSOLID lubrication

- Full Pack application (100% free volume)
- NSF approved category H1 Registration number 154154 (NSF white book)
- Operating temperature :
 - -10°C to +80°C continuous
 - +100°C peak



Nitrile seal

- Stainless steel frame
- Blue colour for better visibility

Benefits

- The LUBSOLID "Full Pack" range, in addition to its seals, provides optimum protection for the bearing in the face of intensive high-pressure washing.
- Solid lubrication eliminates lubricant leakage. Its polymer matrix works like a sponge retaining the oil and releases only the quantity required for perfect lubrication of the raceways and rolling elements.
- LUBSOLID contains up to 4 times more oil than standard grease, which also contributes to longer bearing life.
- Maintenance interventions to change bearings on are less frequent, saving time and production downtime. The budget allocated to bearing replacement is significantly reduced.

Designation

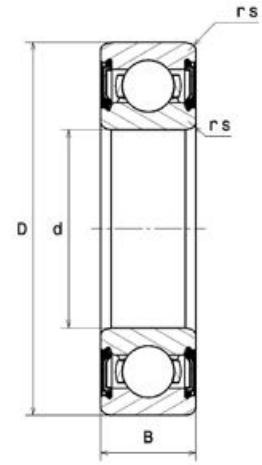
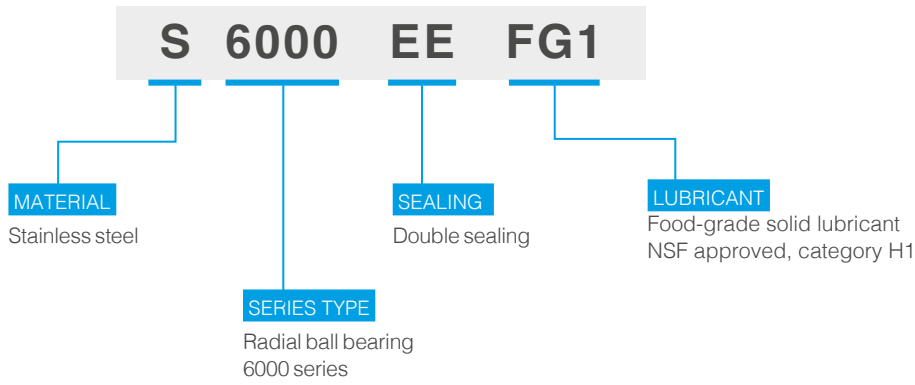

Product references

Reference	Dimensions (mm)				Basic load rating (kN)		*Limiting speed (rpm)	Weight (kg)
	d	D	B	rs	Cr	Co		
S6000EEFG1	10	26	8	0,3	3,52	1,97	1900	0,020
S6001EEFG1	12	28	8	0,3	3,93	2,39	1700	0,022
S6002EEFG1	15	32	9	0,3	4,3	2,85	1500	0,032
S6003EEFG1	17	35	10	0,3	4,6	3,25	1300	0,042
S6004EEFG1	20	42	12	0,6	7,2	5	1100	0,070
S6005EEFG1	25	47	12	0,6	7,7	5,9	1000	0,083
S6006EEFG1	30	55	13	1	10,2	8,3	800	0,120
S6007EEFG1	35	62	14	1	12,3	10,3	700	0,158
S6008EEFG1	40	68	15	1	12,9	11,5	650	0,198
S6200EEFG1	10	30	9	0,6	3,93	2,39	1700	0,033
S6201EEFG1	12	32	10	0,6	5,2	3,05	1600	0,038
S6202EEFG1	15	35	11	0,6	5,9	3,7	1400	0,047
S6203EEFG1	17	40	12	0,6	7,4	4,8	1200	0,069
S6204EEFG1	20	47	14	1	9,9	6,7	1000	0,109
S6205EEFG1	25	52	15	1	10,8	7,9	900	0,136
S6206EEFG1	30	62	16	1	15	11,3	750	0,208
S6207EEFG1	35	72	17	1,1	19,7	15,3	650	0,299
S6208EEFG1	40	80	18	1,1	22,7	18,1	580	0,383
S6300EEFG1	10	35	11	0,6	5,9	3,45	1500	0,056
S6301EEFG1	12	37	12	1	7,5	4,2	1400	0,062
S6302EEFG1	15	42	13	1	8,8	5,4	1200	0,087
S6303EEFG1	17	47	14	1	10,4	6,6	1100	0,118
S6304EEFG1	20	52	15	1,1	12,3	7,9	950	0,150
S6305EEFG1	25	62	17	1,1	17,2	11,5	800	0,237

* Limiting speed values are valid for a bearing used in a room at an ambient temperature of around 20°C. For use in an environment at t° > 20°C, the Limiting speed will be reduced; please contact your NTN technical contact.