



Brand of **NTN Group**

BEARING UNITS & INSERTS

UCP2 / USP2 / EXP2

UCF2 / USF2 / EXF2

UCFL2 / USFL2 / EXFL2

UC2 / US2 / EX2

THE ESSENTIALS



SNR is a brand of NTN Corporation

With 100 years of experience, SNR brand is famous worldwide for its leading position in the Automotive market (wheel, clutch, gearbox, suspension). SNR production and quality levels are also particularly appreciated in the Aerospace industry, typically in aircraft turbo-engines and helicopter gearboxes and blade roots.

SNR has used all its design and manufacturing know-how for the development of the SNR ball bearing unit range by implementing the most severe specifications and the strongest quality processes.



Headquartered in Osaka, Japan, NTN is a leading manufacturer of precision mechanical parts and components. Particularly in the world bearing market, NTN has the largest market share of hub bearings and the second largest of driveshafts. NTN products lead the world with a high level of quality, and are chosen by companies around the world.

Because efficiency is a must

NTN proposes a compact bearing unit range with the SNR brand:
just the essential of dimensions and options,
benefiting from premium brand quality.



YOUR BENEFITS USING THIS RANGE

Boost your **COMPETITIVENESS** without compromising technical performance

Profit from high volume popular bearings designed with premium specifications only.

Increase your purchasing **EFFICIENCY**

No additional supplier in your panel requested. Your NTN sales engineer supplies both NTN and SNR brand offers.

Make your logistics and quality process **SMOOTH**

Continue business as usual with NTN.

Technical key points

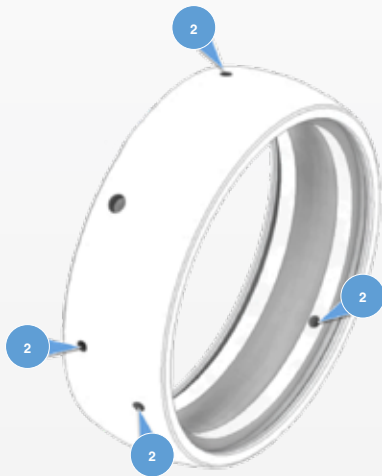
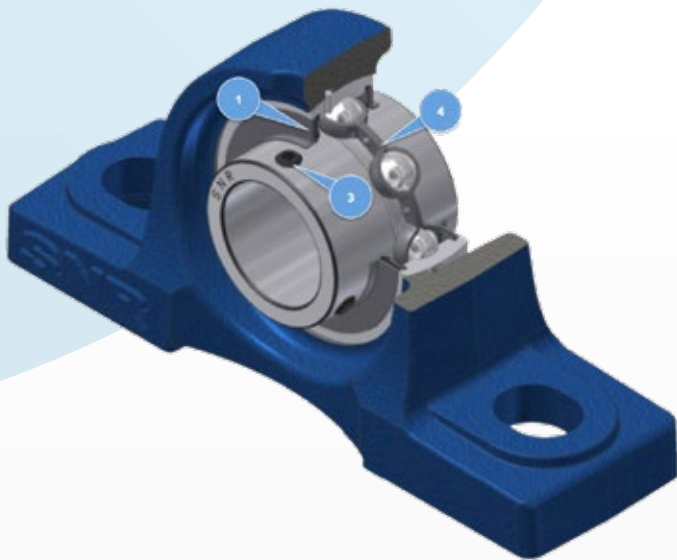

System G2: outer ring with 4 lubrication holes in 2 lines

Seals (1)

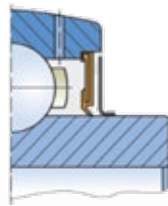

UC200G2 and EX200G2

Nitrile rubber single lip seal reinforced by a metal core with an additional deflector shield

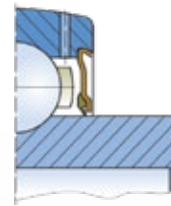

US200G2

Nitrile rubber single lip seal over-moulded on sheet metal ring

Lubrication system G2 (2)

SNR bearing inserts are equipped with 4 lubrication bores in 2 lines. This re-lubrication system allows reversed installation of inserts and can thus be used in both SNR housing designs (Asian and European).

Shaft fixation (3)

Bearing inserts type UC and US are attached to the shaft by means of set screws. EX inserts are fixed by an eccentric locking collar secured by a set screw.

SNR set screw type: knurled design.



Radial bearing clearance

SNR bearing inserts are manufactured with increased bearing clearance Group N acc. to ISO 9628.

Cage (4)

All SNR bearing inserts are equipped with steel cages as standard.

BU catalogue

Bearing inserts

Remarks

Bearing inserts use different versions of set screws.

NTN bearing inserts: **UC200 / AS200:** ball point type
UEL200: cup point type (eccentric locking collar)

SNR bearing inserts: **UC200 / US200 / EX200:** knurled cup point type

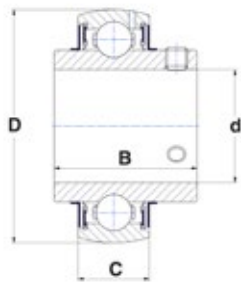

UC200G2

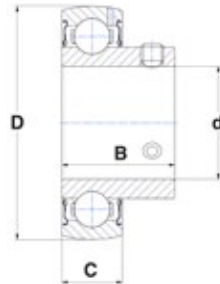

US200G2

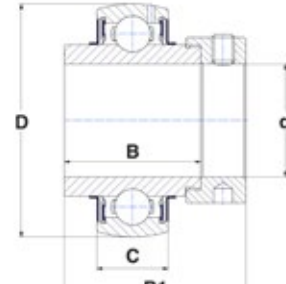

EX200G2

NTN corresponding part number	SNR BRAND									
	SNR part number	Bore diameter (d in mm)	Outer diameter (D in mm)	Width of OR (C in mm)	Width of IR (B in mm)	Overall width incl. eccentric locking collar (B1 in mm)	Weight (kg)	Dynamic load (kN)	Static load (kN)	Admissible working temperature range
UC204-012D1	UC204-12G2	19,05	47	16	31	-	0,17	12,80	6,65	from -20C° to +100C°
UC204D1	UC204G2	20	47	16	31	-	0,17	12,80	6,65	from -20C° to +100C°
UC205-014D1	UC205-14G2	22,225	52	17	34	-	0,21	14,00	7,88	from -20C° to +100C°
UC205-015D1	UC205-15G2	23,813	52	17	34	-	0,21	14,00	7,88	from -20C° to +100C°
UC205-100D1	UC205-16G2	25,4	52	17	34	-	0,2	14,00	7,88	from -20C° to +100C°
UC205D1	UC205G2	25	52	17	34	-	0,21	14,00	7,88	from -20C° to +100C°
UC206-102D1	UC206-18G2	28,575	62	19	38,1	-	0,34	19,50	11,20	from -20C° to +100C°
UC206-103D1	UC206-19G2	30,163	62	19	38,1	-	0,31	19,50	11,20	from -20C° to +100C°
UC206-104D1	UC206-20G2	31,75	62	19	38,1	-	0,3	19,50	11,20	from -20C° to +100C°
UC206D1	UC206G2	30	62	19	38,1	-	0,32	19,50	11,20	from -20C° to +100C°
UC207-104D1	UC207-20G2	31,75	72	20	42,9	-	0,53	25,70	15,20	from -20C° to +100C°
UC207-105D1	UC207-21G2	33,338	72	20	42,9	-	0,51	25,70	15,20	from -20C° to +100C°
UC207-106D1	UC207-22G2	34,925	72	20	42,9	-	0,48	25,70	15,20	from -20C° to +100C°
UC207-107D1	UC207-23G2	36,513	72	20	42,9	-	0,45	25,70	15,20	from -20C° to +100C°
UC207D1	UC207G2	35	72	20	42,9	-	0,47	25,70	15,20	from -20C° to +100C°
UC208-108D1	UC208-24G2	38,1	80	21	49,2	-	0,68	29,60	18,20	from -20C° to +100C°
UC208-109D1	UC208-25G2	39,688	80	21	49,2	-	0,65	29,60	18,20	from -20C° to +100C°
UC208D1	UC208G2	40	80	21	49,2	-	0,64	29,60	18,20	from -20C° to +100C°
UC209-110D1	UC209-26G2	41,275	85	22	49,2	-	0,78	31,85	20,80	from -20C° to +100C°
UC209-111D1	UC209-27G2	42,863	85	22	49,2	-	0,74	31,85	20,80	from -20C° to +100C°
UC209-112D1	UC209-28G2	44,45	85	22	49,2	-	0,7	31,85	20,80	from -20C° to +100C°
UC209D1	UC209G2	45	85	22	49,2	-	0,68	31,85	20,80	from -20C° to +100C°
UC210-114D1	UC210-30G2	47,625	90	23	51,6	-	0,87	35,10	23,20	from -20C° to +100C°
UC210-115D1	UC210-31G2	49,213	90	23	51,6	-	0,82	35,10	23,20	from -20C° to +100C°
UC210D1	UC210G2	50	90	23	51,6	-	0,8	35,10	23,20	from -20C° to +100C°
UC211-200D1	UC211-32G2	50,8	100	25	55,6	-	1,27	43,55	29,20	from -20C° to +100C°
UC211-202D1	UC211-34G2	53,975	100	25	55,6	-	1,17	43,55	29,20	from -20C° to +100C°
UC211-203D1	UC211-35G2	55,563	100	25	55,6	-	1,1	43,55	29,20	from -20C° to +100C°
UC211D1	UC211G2	55	100	25	55,6	-	1,12	43,55	29,20	from -20C° to +100C°
UC212-204D1	UC212-36G2	57,15	110	27	65,1	-	1,67	52,50	32,80	from -20C° to +100C°
UC212-206D1	UC212-38G2	60,325	110	27	65,1	-	1,53	52,50	32,80	from -20C° to +100C°
UC212-207D1	UC212-39G2	61,913	110	27	65,1	-	1,45	52,50	32,80	from -20C° to +100C°
UC212D1	UC212G2	60	110	27	65,1	-	1,53	52,50	32,80	from -20C° to +100C°
UEL204-012D1W3	EX204-12G2	19,05	47	16	34	43,5	0,22	12,80	6,65	from -20C° to +100C°

BU catalogue

Bearing inserts

Remarks

Bearing inserts use different versions of set screws.

NTN bearing inserts: **UC200 / AS200:** ball point type
UEL200: cup point type (eccentric locking collar)

SNR bearing inserts: **UC200 / US200 / EX200:** knurled cup point type

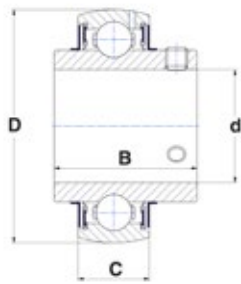

UC200G2

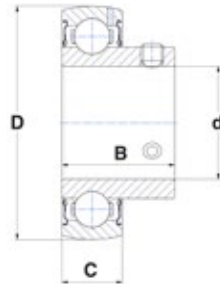

US200G2

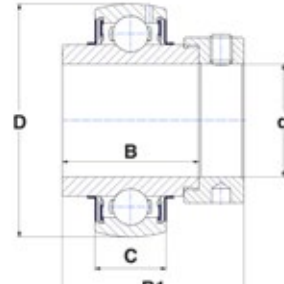

EX200G2

NTN corresponding part number	SNR BRAND									
	SNR part number	Bore diameter (d in mm)	Outer diameter (D in mm)	Width of OR (C in mm)	Width of IR (B in mm)	Overall width incl. eccentric locking collar (B1 in mm)	Weight (kg)	Dynamic load (kN)	Static load (kN)	Admissible working temperature range
UEL204D1W3	EX204G2	20	47	16	34	43,5	0,22	12,80	6,65	from -20C° to +100C°
UEL205-014D1W3	EX205-14G2	22,225	52	17	34,8	44,3	0,25	14,00	7,88	from -20C° to +100C°
UEL205-015D1W3	EX205-15G2	23,813	52	17	34,8	44,3	0,25	14,00	7,88	from -20C° to +100C°
UEL205-100D1W3	EX205-16G2	25,4	52	17	34,8	44,3	0,24	14,00	7,88	from -20C° to +100C°
UEL205D1W3	EX205G2	25	52	17	34,8	44,3	0,25	14,00	7,88	from -20C° to +100C°
UEL206-102D1W3	EX206-18G2	28,575	62	19	36,4	48,3	0,43	19,50	11,20	from -20C° to +100C°
UEL206-103D1W3	EX206-19G2	30,163	62	19	36,4	48,3	0,4	19,50	11,20	from -20C° to +100C°
UEL206-104D1W3	EX206-20G2	31,75	62	19	36,4	48,3	0,38	19,50	11,20	from -20C° to +100C°
UEL206D1W3	EX206G2	30	62	19	36,4	48,3	0,41	19,50	11,20	from -20C° to +100C°
UEL207-104D1W3	EX207-20G2	31,75	72	20	37,6	51,1	0,66	25,70	15,20	from -20C° to +100C°
UEL207-105D1W3	EX207-21G2	33,338	72	20	37,6	51,1	0,64	25,70	15,20	from -20C° to +100C°
UEL207-106D1W3	EX207-22G2	34,925	72	20	37,6	51,1	0,61	25,70	15,20	from -20C° to +100C°
UEL207-107D1W3	EX207-23G2	36,513	72	20	37,6	51,1	0,58	25,70	15,20	from -20C° to +100C°
UEL207D1W3	EX207G2	35	72	20	37,6	51,1	0,60	25,70	15,20	from -20C° to +100C°
UEL208-108D1W3	EX208-24G2	38,1	80	21	42,8	56,3	0,83	29,60	18,20	from -20C° to +100C°
UEL208-109D1W3	EX208-25G2	39,688	80	21	42,8	56,3	0,82	29,60	18,20	from -20C° to +100C°
UEL208D1W3	EX208G2	40	80	21	42,8	56,3	0,78	29,60	18,20	from -20C° to +100C°
UEL209-110D1W3	EX209-26G2	41,275	85	22	42,8	56,3	0,96	31,85	20,80	from -20C° to +100C°
UEL209-111D1W3	EX209-27G2	42,863	85	22	42,8	56,3	0,91	31,85	20,80	from -20C° to +100C°
UEL209-112D1W3	EX209-28G2	44,45	85	22	42,8	56,3	0,87	31,85	20,80	from -20C° to +100C°
UEL209D1W3	EX209G2	45	85	22	42,8	56,3	0,87	31,85	20,80	from -20C° to +100C°
UEL210-114D1W3	EX210-30G2	47,625	90	23	49,2	62,7	1,10	35,10	23,20	from -20C° to +100C°
UEL210-115D1W3	EX210-31G2	49,213	90	23	49,2	62,7	1,04	35,10	23,20	from -20C° to +100C°
UEL210D1W3	EX210G2	50	90	23	49,2	62,7	1,01	35,10	23,20	from -20C° to +100C°
UEL211-200D1W3	EX211-32G2	50,8	100	25	55,4	71,3	1,58	43,55	29,20	from -20C° to +100C°
UEL211-202D1W3	EX211-34G2	53,975	100	25	55,4	71,3	1,38	43,55	29,20	from -20C° to +100C°
UEL211-203D1W3	EX211-35G2	55,563	100	25	55,4	71,3	1,36	43,55	29,20	from -20C° to +100C°
UEL211D1W3	EX211G2	55	100	25	55,4	71,3	1,39	43,55	29,20	from -20C° to +100C°
UEL212-204D1W3	EX212-36G2	57,15	110	27	61,8	77,7	2,03	52,50	32,80	from -20C° to +100C°
UEL212-206D1W3	EX212-38G2	60,325	110	27	61,8	77,7	1,80	52,50	32,80	from -20C° to +100C°
UEL212-207D1W3	EX212-39G2	61,913	110	27	61,8	77,7	1,76	52,50	32,80	from -20C° to +100C°
UEL212D1W3	EX212G2	60	110	27	61,8	77,7	1,87	52,50	32,80	from -20C° to +100C°
AS204-012D1	US204-12G2	19,05	47	14	25	-	0,13	12,80	6,65	from -20C° to +100C°
AS204D1	US204G2	20	47	14	25	-	0,13	12,80	6,65	from -20C° to +100C°

NTN corresponding part number	SNR BRAND									
	SNR part number	Bore diameter (d in mm)	Outer diameter (D in mm)	Width of OR (C in mm)	Width of IR (B in mm)	Overall width incl. eccent. locking collar (B1 in mm)	Weight (kg)	Dynamic load (kN)	Static load (kN)	Admissible working temperature range
AS205-014D1	US205-14G2	22,225	52	15	27	-	0,18	14,00	7,88	from -20C° to +100C°
AS205-015D1	US205-15G2	23,813	52	15	27	-	0,18	14,00	7,88	from -20C° to +100C°
AS205-100D1	US205-16G2	25,4	52	15	27	-	0,16	14,00	7,88	from -20C° to +100C°
AS205D1	US205G2	25	52	15	27	-	0,17	14,00	7,88	from -20C° to +100C°
AS206-102D1	US206-18G2	28,575	62	16	30	-	0,28	19,50	11,20	from -20C° to +100C°
AS206-103D1	US206-19G2	30,163	62	16	30	-	0,25	19,50	11,20	from -20C° to +100C°
AS206-104D1	US206-20G2	31,75	62	16	30	-	0,24	19,50	11,20	from -20C° to +100C°
AS206D1	US206G2	30	62	16	30	-	0,27	19,50	11,20	from -20C° to +100C°
AS207-106D1	US207-22G2	34,925	72	17	32	-	0,38	25,70	15,20	from -20C° to +100C°
AS207-107D1	US207-23G2	36,513	72	17	32	-	0,37	25,70	15,20	from -20C° to +100C°
AS207D1	US207G2	35	72	17	32	-	0,42	25,70	15,20	from -20C° to +100C°
AS208-108D1	US208-24G2	38,1	80	18	34	-	0,60	29,60	18,20	from -20C° to +100C°
AS208D1	US208G2	40	80	18	34	-	0,60	29,60	18,20	from -20C° to +100C°
AS209-110D1	US209-26G2	41,275	85	19	41,2	-	0,75	31,85	20,80	from -20C° to +100C°
AS209-111D1	US209-27G2	42,863	85	19	41,2	-	0,72	31,85	20,80	from -20C° to +100C°
AS209-112D1	US209-28G2	44,45	85	19	41,2	-	0,67	31,85	20,80	from -20C° to +100C°
AS209D1	US209G2	45	85	19	41,2	-	0,65	31,85	20,80	from -20C° to +100C°
AS210-114D1	US210-30G2	47,625	90	20	43,5	-	0,80	35,10	23,20	from -20C° to +100C°
AS210-115D1	US210-31G2	49,213	90	20	43,5	-	0,78	35,10	23,20	from -20C° to +100C°
AS210D1	US210G2	50	90	20	43,5	-	0,76	35,10	23,20	from -20C° to +100C°
-	US211-32G2	50,8	100	23	45,3	-	1,10	43,55	29,20	from -20C° to +100C°
-	US211-35G2	55,563	100	23	45,3	-	1,05	43,55	29,20	from -20C° to +100C°
-	US211G2	55	100	23	45,3	-	1,07	43,55	29,20	from -20C° to +100C°
-	US212-36G2	57,15	110	24	53,7	-	1,30	52,50	32,80	from -20C° to +100C°
-	US212-39G2	61,913	110	24	53,7	-	1,22	52,50	32,80	from -20C° to +100C°
-	US212G2	60	110	24	53,7	-	1,30	52,50	32,80	from -20C° to +100C°

BU catalogue

Pillow block units

Remarks

Bearing inserts use different versions of set screws.

NTN bearing inserts: **UC200 / AS200:** ball point type
UEL200: cup point type (eccentric locking collar)

SNR bearing inserts: **UC200 / US200 / EX200:** knurled cup point type

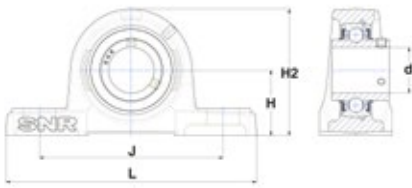

UCP200

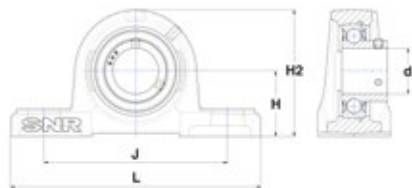

USP200

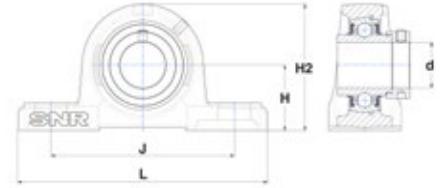

EXP200

NTN corresponding part number	SNR BRAND								
	SNR part number Bearing Unit	SNR part number Housing	SNR part number Bearing	Bore diameter (d in mm)	Housing length (L in mm)	Mounting hole distance (J in mm)	Housing height (H2 in mm)	Shaft center height (H in mm)	Weight (kg)
UCP204-012D1	UCP204-12	P204	UC204-12G2	19,05	127	95	65	33,3	0,67
UCP204D1	UCP204	P204	UC204G2	20	127	95	65	33,3	0,67
UCP205-014D1	UCP205-14	P205	UC205-14G2	22,225	140	105	70	36,5	0,81
UCP205-015D1	UCP205-15	P205	UC205-15G2	23,813	140	105	70	36,5	0,81
UCP205-100D1	UCP205-16	P205	UC205-16G2	25,4	140	105	70	36,5	0,80
UCP205D1	UCP205	P205	UC205G2	25	140	105	70	36,5	0,81
UCP206-102D1	UCP206-18	P206	UC206-18G2	28,575	165	121	83	42,9	1,44
UCP206-103D1	UCP206-19	P206	UC206-19G2	30,163	165	121	83	42,9	1,41
UCP206-104D1	UCP206-20	P206	UC206-20G2	31,75	165	121	83	42,9	1,40
UCP206D1	UCP206	P206	UC206G2	30	165	121	83	42,9	1,42
UCP207-104D1	UCP207-20	P207	UC207-20G2	31,75	167	127	94	47,6	1,73
UCP207-105D1	UCP207-21	P207	UC207-21G2	33,338	167	127	94	47,6	1,71
UCP207-106D1	UCP207-22	P207	UC207-22G2	34,925	167	127	94	47,6	1,68
UCP207-107D1	UCP207-23	P207	UC207-23G2	36,513	167	127	94	47,6	1,65
UCP207D1	UCP207	P207	UC207G2	35	167	127	94	47,6	1,67
UCP208-108D1	UCP208-24	P208	UC208-24G2	38,1	184	137	100	49,2	2,18
UCP208-109D1	UCP208-25	P208	UC208-25G2	39,688	184	137	100	49,2	2,15
UCP208D1	UCP208	P208	UC208G2	40	184	137	100	49,2	2,14
UCP209-110D1	UCP209-26	P209	UC209-26G2	41,275	190	146	108	54	2,48
UCP209-111D1	UCP209-27	P209	UC209-27G2	42,863	190	146	108	54	2,44
UCP209-112D1	UCP209-28	P209	UC209-28G2	44,45	190	146	108	54	2,40
UCP209D1	UCP209	P209	UC209G2	45	190	146	108	54	2,38
UCP210-114D1	UCP210-30	P210	UC210-30G2	47,625	206	159	114	57,2	3,07
UCP210-115D1	UCP210-31	P210	UC210-31G2	49,213	206	159	114	57,2	3,02
UCP210D1	UCP210	P210	UC210G2	50	206	159	114	57,2	3,00
UCP211-200D1	UCP211-32	P211	UC211-32G2	50,8	219	171	126	63,5	3,87
UCP211-202D1	UCP211-34	P211	UC211-34G2	53,975	219	171	126	63,5	3,77
UCP211-203D1	UCP211-35	P211	UC211-35G2	55,563	219	171	126	63,5	3,70
UCP211D1	UCP211	P211	UC211G2	55	219	171	126	63,5	3,72
UCP212-204D1	UCP212-36	P212	UC212-36G2	57,15	241	184	138	69,8	5,17
UCP212-206D1	UCP212-38	P212	UC212-38G2	60,325	241	184	138	69,8	5,03
UCP212-207D1	UCP212-39	P212	UC212-39G2	61,913	241	184	138	69,8	4,95
UCP212D1	UCP212	P212	UC212G2	60	241	184	138	69,8	5,03
UEL204-012D1W3	EXP204-12	P204	EX204-12G2	19,05	127	95	65	33,3	0,72
UEL204D1W3	EXP204	P204	EX204G2	20	127	95	65	33,3	0,72
UEL205-014D1W3	EXP205-14	P205	EX205-14G2	22,225	140	105	70	36,5	0,85
UEL205-015D1W3	EXP205-15	P205	EX205-15G2	23,813	140	105	70	36,5	0,85
UEL205-100D1W3	EXP205-16	P205	EX205-16G2	25,4	140	105	70	36,5	0,84
UEL205D1W3	EXP205	P205	EX205G2	25	140	105	70	36,5	0,85
UEL206-102D1W3	EXP206-18	P206	EX206-18G2	28,575	165	121	83	42,9	1,53
UEL206-103D1W3	EXP206-19	P206	EX206-19G2	30,163	165	121	83	42,9	1,50
UEL206-104D1W3	EXP206-20	P206	EX206-20G2	31,75	165	121	83	42,9	1,48
UEL206D1W3	EXP206	P206	EX206G2	30	165	121	83	42,9	1,51
UEL207-104D1W3	EXP207-20	P207	EX207-20G2	31,75	167	127	94	47,6	1,86
UEL207-105D1W3	EXP207-21	P207	EX207-21G2	33,338	167	127	94	47,6	1,84
UEL207-106D1W3	EXP207-22	P207	EX207-22G2	34,925	167	127	94	47,6	1,81
UEL207-107D1W3	EXP207-23	P207	EX207-23G2	36,513	167	127	94	47,6	1,78

BU catalogue

Pillow block units

Remarks

Bearing inserts use different versions of set screws.

NTN bearing inserts: **UC200 / AS200:** ball point type
UEL200: cup point type (eccentric locking collar)

SNR bearing inserts: **UC200 / US200 / EX200:** knurled cup point type

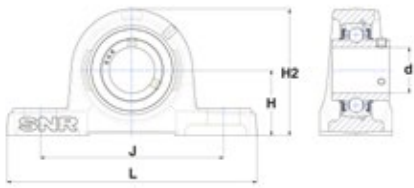

UCP200

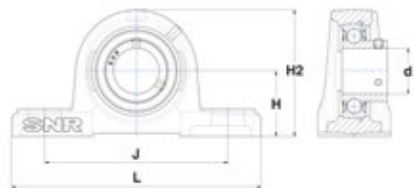

USP200

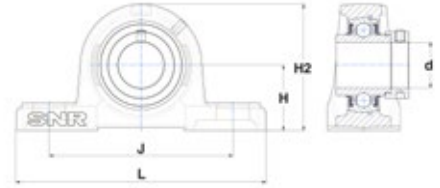

EXP200

NTN corresponding part number	SNR BRAND								
	SNR part number Bearing Unit	SNR part number Housing	SNR part number Bearing	Bore diameter (d in mm)	Housing length (L in mm)	Mounting hole distance (J in mm)	Housing height (H2 in mm)	Shaft center height (H in mm)	Weight (kg)
UEL207D1W3	EXP207	P207	EX207G2	35	167	127	94	47,6	1,80
UEL208-108D1W3	EXP208-24	P208	EX208-24G2	38,1	184	137	100	49,2	2,33
UEL208-109D1W3	EXP208-25	P208	EX208-25G2	39,688	184	137	100	49,2	2,32
UEL208D1W3	EXP208	P208	EX208G2	40	184	137	100	49,2	2,28
UEL209-110D1W3	EXP209-26	P209	EX209-26G2	41,275	190	146	108	54	2,66
UEL209-111D1W3	EXP209-27	P209	EX209-27G2	42,863	190	146	108	54	2,61
UEL209-112D1W3	EXP209-28	P209	EX209-28G2	44,45	190	146	108	54	2,57
UEL209D1W3	EXP209	P209	EX209G2	45	190	146	108	54	2,57
UEL210-114D1W3	EXP210-30	P210	EX210-30G2	47,625	206	159	114	57,2	3,30
UEL210-115D1W3	EXP210-31	P210	EX210-31G2	49,213	206	159	114	57,2	3,24
UEL210D1W3	EXP210	P210	EX210G2	50	206	159	114	57,2	3,21
UEL211-200D1W3	EXP211-32	P211	EX211-32G2	50,8	219	171	126	63,5	4,18
UEL211-202D1W3	EXP211-34	P211	EX211-34G2	53,975	219	171	126	63,5	3,98
UEL211-203D1W3	EXP211-35	P211	EX211-35G2	55,563	219	171	126	63,5	3,96
UEL211D1W3	EXP211	P211	EX211G2	55	219	171	126	63,5	3,99
UEL212-204D1W3	EXP212-36	P212	EX212-36G2	57,15	241	184	138	69,8	5,53
UEL212-206D1W3	EXP212-38	P212	EX212-38G2	60,325	241	184	138	69,8	5,30
UEL212-207D1W3	EXP212-39	P212	EX212-39G2	61,913	241	184	138	69,8	5,26
UEL212D1W3	EXP212	P212	EX212G2	60	241	184	138	69,8	5,37
ASP204-012D1	USP204-12	P204	US204-12G2	19,05	127	95	65	33,3	0,63
ASP204D1	USP204	P204	US204G2	20	127	95	65	33,3	0,63
ASP205-014D1	USP205-14	P205	US205-14G2	22,225	140	105	70	36,5	0,78
ASP205-015D1	USP205-15	P205	US205-15G2	23,813	140	105	70	36,5	0,78
ASP205-100D1	USP205-16	P205	US205-16G2	25,4	140	105	70	36,5	0,76
ASP205D1	USP205	P205	US205G2	25	140	105	70	36,5	0,77
ASP206-102D1	USP206-18	P206	US206-18G2	28,575	165	121	83	42,9	1,38
ASP206-103D1	USP206-19	P206	US206-19G2	30,163	165	121	83	42,9	1,35
ASP206-104D1	USP206-20	P206	US206-20G2	31,75	165	121	83	42,9	1,34
ASP206D1	USP206	P206	US206G2	30	165	121	83	42,9	1,37
ASP207-106D1	USP207-22	P207	US207-22G2	34,925	167	127	94	47,6	1,58
ASP207-107D1	USP207-23	P207	US207-23G2	36,513	167	127	94	47,6	1,57
ASP207D1	USP207	P207	US207G2	35	167	127	94	47,6	1,62
ASP208-108D1	USP208-24	P208	US208-24G2	38,1	184	137	100	49,2	2,10
ASP208D1	USP208	P208	US208G2	40	184	137	100	49,2	2,10
ASP209-110D1	USP209-26	P209	US209-26G2	41,275	190	146	108	54	2,45
ASP209-111D1	USP209-27	P209	US209-27G2	42,863	190	146	108	54	2,42
ASP209-112D1	USP209-28	P209	US209-28G2	44,45	190	146	108	54	2,37
ASP209D1	USP209	P209	US209G2	45	190	146	108	54	2,35
ASP210-114D1	USP210-30	P210	US210-30G2	47,625	206	159	114	57,2	3,00
ASP210-115D1	USP210-31	P210	US210-31G2	49,213	206	159	114	57,2	2,98
ASP210D1	USP210	P210	US210G2	50	206	159	114	57,2	2,96
-	USP211-32	P211	US211-32G2	50,8	219	171	126	63,5	3,70
-	USP211-35	P211	US211-35G2	55,563	219	171	126	63,5	3,65
-	USP211	P211	US211G2	55	219	171	126	63,5	3,67
-	USP212-36	P212	US212-36G2	57,15	241	184	138	69,8	4,80
-	USP212-39	P212	US212-39G2	61,913	241	184	138	69,8	4,72
-	USP212	P212	US212G2	60	241	184	138	69,8	4,80

BU catalogue

4-Bolt flanged units

Remarks

Bearing inserts use different versions of set screws.

NTN bearing inserts: **UC200 / AS200:** ball point type
UEL200: cup point type (eccentric locking collar)

SNR bearing inserts: **UC200 / US200 / EX200:** knurled cup point type

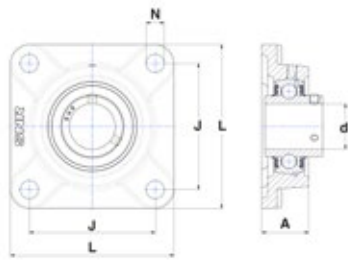

UCFP200

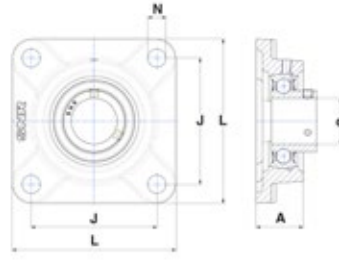

USFP200

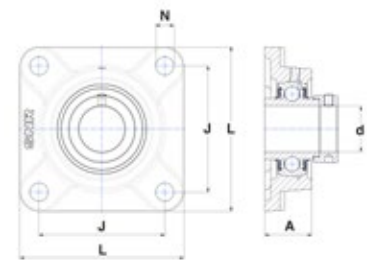

EXF200

NTN corresponding part number	SNR BRAND								
	SNR part number Bearing Unit	SNR part number Housing	SNR part number Bearing	Bore diameter (d in mm)	Housing length (L in mm)	Mounting hole distance (J in mm)	Housing height (A in mm)	Mounting bore Ø (N in mm)	Weight (kg)
UCF204-012D1	UCF204-12	F204	UC204-12G2	19,05	86	64	25,5	12	0,57
UCF204D1	UCF204	F204	UC204G2	20	86	64	25,5	12	0,57
UCF205-014D1	UCF205-14	F205	UC205-14G2	22,225	95	70	27	12	0,81
UCF205-015D1	UCF205-15	F205	UC205-15G2	23,813	95	70	27	12	0,81
UCF205-100D1	UCF205-16	F205	UC205-16G2	25,4	95	70	27	12	0,80
UCF205D1	UCF205	F205	UC205G2	25	95	70	27	12	0,81
UCF206-102D1	UCF206-18	F206	UC206-18G2	28,575	108	83	31	12	1,14
UCF206-103D1	UCF206-19	F206	UC206-19G2	30,163	108	83	31	12	1,11
UCF206-104D1	UCF206-20	F206	UC206-20G2	31,75	108	83	31	12	1,10
UCF206D1	UCF206	F206	UC206G2	30	108	83	31	12	1,12
UCF207-104D1	UCF207-20	F207	UC207-20G2	31,75	117	92	34	14	1,53
UCF207-105D1	UCF207-21	F207	UC207-21G2	33,338	117	92	34	14	1,51
UCF207-106D1	UCF207-22	F207	UC207-22G2	34,925	117	92	34	14	1,48
UCF207-107D1	UCF207-23	F207	UC207-23G2	36,513	117	92	34	14	1,45
UCF207D1	UCF207	F207	UC207G2	35	117	92	34	14	1,47
UCF208-108D1	UCF208-24	F208	UC208-24G2	38,1	130	102	36	16	1,98
UCF208-109D1	UCF208-25	F208	UC208-25G2	39,688	130	102	36	16	1,95
UCF208D1	UCF208	F208	UC208G2	40	130	102	36	16	1,94
UCF209-110D1	UCF209-26	F209	UC209-26G2	41,275	137	105	38	16	2,28
UCF209-111D1	UCF209-27	F209	UC209-27G2	42,863	137	105	38	16	2,24
UCF209-112D1	UCF209-28	F209	UC209-28G2	44,45	137	105	38	16	2,20
UCF209D1	UCF209	F209	UC209G2	45	137	105	38	16	2,18
UCF210-114D1	UCF210-30	F210	UC210-30G2	47,625	143	111	40	16	2,57
UCF210-115D1	UCF210-31	F210	UC210-31G2	49,213	143	111	40	16	2,52
UCF210D1	UCF210	F210	UC210G2	50	143	111	40	16	2,50
UCF211-200D1	UCF211-32	F211	UC211-32G2	50,8	162	130	43	19	3,47
UCF211-202D1	UCF211-34	F211	UC211-34G2	53,975	162	130	43	19	3,37
UCF211-203D1	UCF211-35	F211	UC211-35G2	55,563	162	130	43	19	3,30
UCF211D1	UCF211	F211	UC211G2	55	162	130	43	19	3,32
UCF212-204D1	UCF212-36	F212	UC212-36G2	57,15	175	143	48	19	4,57
UCF212-206D1	UCF212-38	F212	UC212-38G2	60,325	175	143	48	19	4,43
UCF212-207D1	UCF212-39	F212	UC212-39G2	61,913	175	143	48	19	4,35
UCF212D1	UCF212	F212	UC212G2	60	175	143	48	19	4,43
UEL204-012D1W3	EXF204-12	F204	EX204-12G2	19,05	86	64	25,5	12	0,62
UEL204D1W3	EXF204	F204	EX204G2	20	86	64	25,5	12	0,62
UEL205-014D1W3	EXF205-14	F205	EX205-14G2	22,225	95	70	27	12	0,85
UEL205-015D1W3	EXF205-15	F205	EX205-15G2	23,813	95	70	27	12	0,85
UEL205-100D1W3	EXF205-16	F205	EX205-16G2	25,4	95	70	27	12	0,84
UEL205D1W3	EXF205	F205	EX205G2	25	95	70	27	12	0,85

BU catalogue

4-Bolt flanged units

Remarks

Bearing inserts use different versions of set screws.

NTN bearing inserts: **UC200 / AS200:** ball point type
UEL200: cup point type (eccentric locking collar)

SNR bearing inserts: **UC200 / US200 / EX200:** knurled cup point type

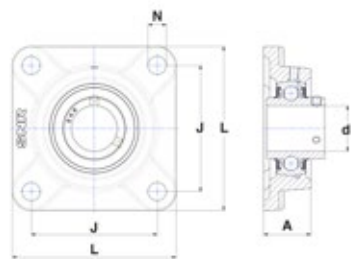

UCFP200

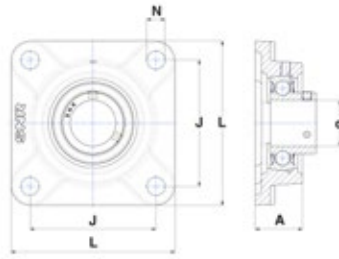

USFP200

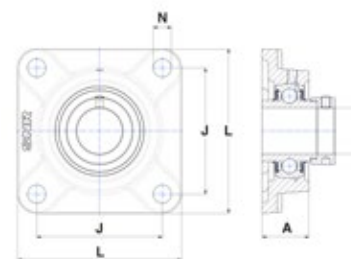

EXF200

NTN corresponding part number	SNR BRAND								
	SNR part number Bearing Unit	SNR part number Housing	SNR part number Bearing	Bore diameter (d in mm)	Housing length (L in mm)	Mounting hole distance (J in mm)	Housing height (A in mm)	Mounting bore Ø (N in mm)	Weight (kg)
UEL206-102D1W3	EXF206-18	F206	EX206-18G2	28,575	108	83	31	12	1,23
UEL206-103D1W3	EXF206-19	F206	EX206-19G2	30,163	108	83	31	12	1,20
UEL206-104D1W3	EXF206-20	F206	EX206-20G2	31,75	108	83	31	12	1,18
UEL206D1W3	EXF206	F206	EX206G2	30	108	83	31	12	1,21
UEL207-104D1W3	EXF207-20	F207	EX207-20G2	31,75	117	92	34	14	1,66
UEL207-105D1W3	EXF207-21	F207	EX207-21G2	33,338	117	92	34	14	1,64
UEL207-106D1W3	EXF207-22	F207	EX207-22G2	34,925	117	92	34	14	1,61
UEL207-107D1W3	EXF207-23	F207	EX207-23G2	36,513	117	92	34	14	1,58
UEL207D1W3	EXF207	F207	EX207G2	35	117	92	34	14	1,60
UEL208-108D1W3	EXF208-24	F208	EX208-24G2	38,1	130	102	36	16	2,13
UEL208-109D1W3	EXF208-25	F208	EX208-25G2	39,688	130	102	36	16	2,12
UEL208D1W3	EXF208	F208	EX208G2	40	130	102	36	16	2,08
UEL209-110D1W3	EXF209-26	F209	EX209-26G2	41,275	137	105	38	16	2,46
UEL209-111D1W3	EXF209-27	F209	EX209-27G2	42,863	137	105	38	16	2,41
UEL209-112D1W3	EXF209-28	F209	EX209-28G2	44,45	137	105	38	16	2,37
UEL209D1W3	EXF209	F209	EX209G2	45	137	105	38	16	2,37
UEL210-114D1W3	EXF210-30	F210	EX210-30G2	47,625	143	111	40	16	2,80
UEL210-115D1W3	EXF210-31	F210	EX210-31G2	49,213	143	111	40	16	2,74
UEL210D1W3	EXF210	F210	EX210G2	50	143	111	40	16	2,71
UEL211-200D1W3	EXF211-32	F211	EX211-32G2	50,8	162	130	43	19	3,78
UEL211-202D1W3	EXF211-34	F211	EX211-34G2	53,975	162	130	43	19	3,58
UEL211-203D1W3	EXF211-35	F211	EX211-35G2	55,563	162	130	43	19	3,56
UEL211D1W3	EXF211	F211	EX211G2	55	162	130	43	19	3,59
UEL212-204D1W3	EXF212-36	F212	EX212-36G2	57,15	175	143	48	19	4,93
UEL212-206D1W3	EXF212-38	F212	EX212-38G2	60,325	175	143	48	19	4,70
UEL212-207D1W3	EXF212-39	F212	EX212-39G2	61,913	175	143	48	19	4,66
UEL212D1W3	EXF212	F212	EX212G2	60	175	143	48	19	4,77
ASF204-012D1	USF204-12	F204	US204-12G2	19,05	86	64	25,5	12	0,53
ASF204D1	USF204	F204	US204G2	20	86	64	25,5	12	0,53
ASF205-014D1	USF205-14	F205	US205-14G2	22,225	95	70	27	12	0,78
ASF205-015D1	USF205-15	F205	US205-15G2	23,813	95	70	27	12	0,78
ASF205-100D1	USF205-16	F205	US205-16G2	25,4	95	70	27	12	0,76
ASF205D1	USF205	F205	US205G2	25	95	70	27	12	0,77
ASF206-102D1	USF206-18	F206	US206-18G2	28,575	108	83	31	12	1,08
ASF206-103D1	USF206-19	F206	US206-19G2	30,163	108	83	31	12	1,05
ASF206-104D1	USF206-20	F206	US206-20G2	31,75	108	83	31	12	1,04
ASF206D1	USF206	F206	US206G2	30	108	83	31	12	1,07
ASF207-106D1	USF207-22	F207	US207-22G2	34,925	117	92	34	14	1,38
ASF207-107D1	USF207-23	F207	US207-23G2	36,513	117	92	34	14	1,37

BU catalogue

4-Bolt flanged units

Remarks

Bearing inserts use different versions of set screws.

NTN bearing inserts: **UC200 / AS200:** ball point type
UEL200: cup point type (eccentric locking collar)

SNR bearing inserts: **UC200 / US200 / EX200:** knurled cup point type

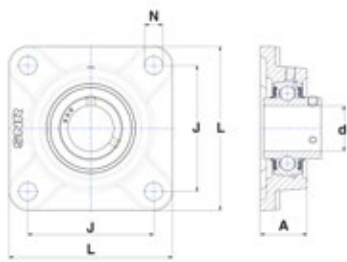

UCFP200

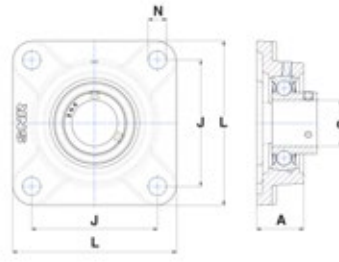

USFP200

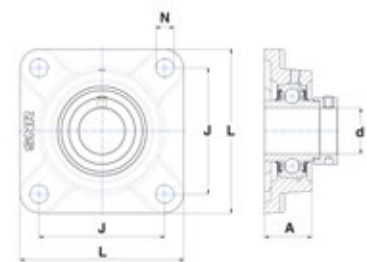

EXF200

NTN corresponding part number	SNR BRAND								
	SNR part number Bearing Unit	SNR part number Housing	SNR part number Bearing	Bore diameter (d in mm)	Housing length (L in mm)	Mounting hole distance (J in mm)	Housing height (A in mm)	Mounting bore Ø (N in mm)	Weight (kg)
ASF207D1	USF207	F207	US207G2	35	117	92	34	14	1,42
ASF208-108D1	USF208-24	F208	US208-24G2	38,1	130	102	36	16	1,90
ASF208D1	USF208	F208	US208G2	40	130	102	36	16	1,90
ASF209-110D1	USF209-26	F209	US209-26G2	41,275	137	105	38	16	2,25
ASF209-111D1	USF209-27	F209	US209-27G2	42,863	137	105	38	16	2,22
ASF209-112D1	USF209-28	F209	US209-28G2	44,45	137	105	38	16	2,17
ASF209D1	USF209	F209	US209G2	45	137	105	38	16	2,15
ASF210-114D1	USF210-30	F210	US210-30G2	47,625	143	111	40	16	2,50
ASF210-115D1	USF210-31	F210	US210-31G2	49,213	143	111	40	16	2,48
ASF210D1	USF210	F210	US210G2	50	143	111	40	16	2,46
-	USF211-32	F211	US211-32G2	50,8	162	130	43	19	3,30
-	USF211-35	F211	US211-35G2	55,563	162	130	43	19	3,25
-	USF211	F211	US211G2	55	162	130	43	19	3,27
-	USF212-36	F212	US212-36G2	57,15	175	143	48	19	4,20
-	USF212-39	F212	US212-39G2	61,913	175	143	48	19	4,12
-	USF212	F212	US212G2	60	175	143	48	19	4,20

BU catalogue

2-Bolt flanged units

Remarks

Bearing inserts use different versions of set screws.

NTN bearing inserts: **UC200 / AS200:** ball point type
UEL200: cup point type (eccentric locking collar)

SNR bearing inserts: **UC200 / US200 / EX200:** knurled cup point type

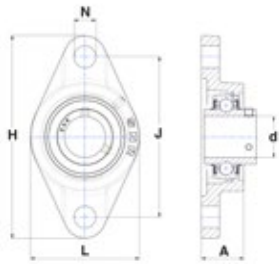

UCFL200

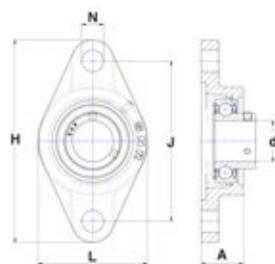

USFL200

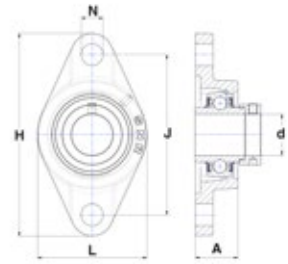

EXFL200

NTN corresponding part number	SNR BRAND									
	SNR part number Bearing Unit	SNR part number Housing	SNR part number Bearing	Bore diameter (d in mm)	Housing length (H in mm)	Mounting hole distance (J in mm)	Housing height (A in mm)	Housing width (L in mm)	Mounting bore Ø (N in mm)	Weight (kg)
UCFL204-012D1	UCFL204-12	FL204	UC204-12G2	19,05	113	90	25,5	60	12	0,47
UCFL204D1	UCFL204	FL204	UC204G2	20	113	90	25,5	60	12	0,47
UCFL205-014D1	UCFL205-14	FL205	UC205-14G2	22,225	130	99	27	68	16	0,61
UCFL205-015D1	UCFL205-15	FL205	UC205-15G2	23,813	130	99	27	68	16	0,61
UCFL205-100D1	UCFL205-16	FL205	UC205-16G2	25,4	130	99	27	68	16	0,60
UCFL205D1	UCFL205	FL205	UC205G2	25	130	99	27	68	16	0,61
UCFL206-102D1	UCFL206-18	FL206	UC206-18G2	28,575	148	117	31	80	16	0,94
UCFL206-103D1	UCFL206-19	FL206	UC206-19G2	30,163	148	117	31	80	16	0,91
UCFL206-104D1	UCFL206-20	FL206	UC206-20G2	31,75	148	117	31	80	16	0,90
UCFL206D1	UCFL206	FL206	UC206G2	30	148	117	31	80	16	0,92
UCFL207-104D1	UCFL207-20	FL207	UC207-20G2	31,75	161	130	34	90	16	1,23
UCFL207-105D1	UCFL207-21	FL207	UC207-21G2	33,338	161	130	34	90	16	1,21
UCFL207-106D1	UCFL207-22	FL207	UC207-22G2	34,925	161	130	34	90	16	1,18
UCFL207-107D1	UCFL207-23	FL207	UC207-23G2	36,513	161	130	34	90	16	1,15
UCFL207D1	UCFL207	FL207	UC207G2	35	161	130	34	90	16	1,17
UCFL208-108D1	UCFL208-24	FL208	UC208-24G2	38,1	175	144	36	100	16	1,58
UCFL208-109D1	UCFL208-25	FL208	UC208-25G2	39,688	175	144	36	100	16	1,55
UCFL208D1	UCFL208	FL208	UC208G2	40	175	144	36	100	16	1,54
UCFL209-110D1	UCFL209-26	FL209	UC209-26G2	41,275	188	148	38	108	19	1,98
UCFL209-111D1	UCFL209-27	FL209	UC209-27G2	42,863	188	148	38	108	19	1,94
UCFL209-112D1	UCFL209-28	FL209	UC209-28G2	44,45	188	148	38	108	19	1,90
UCFL209D1	UCFL209	FL209	UC209G2	45	188	148	38	108	19	1,88
UCFL210-114D1	UCFL210-30	FL210	UC210-30G2	47,625	197	157	40	115	19	2,27
UCFL210-115D1	UCFL210-31	FL210	UC210-31G2	49,213	197	157	40	115	19	2,22
UCFL210D1	UCFL210	FL210	UC210G2	50	197	157	40	115	19	2,20
UCFL211-200D1	UCFL211-32	FL211	UC211-32G2	50,8	224	184	43	130	19	3,17
UCFL211-202D1	UCFL211-34	FL211	UC211-34G2	53,975	224	184	43	130	19	3,07
UCFL211-203D1	UCFL211-35	FL211	UC211-35G2	55,563	224	184	43	130	19	3,00
UCFL211D1	UCFL211	FL211	UC211G2	55	224	184	43	130	19	3,02
UCFL212-204D1	UCFL212-36	FL212	UC212-36G2	57,15	250	202	48	140	23	3,97
UCFL212-206D1	UCFL212-38	FL212	UC212-38G2	60,325	250	202	48	140	23	3,83
UCFL212-207D1	UCFL212-39	FL212	UC212-39G2	61,913	250	202	48	140	23	3,75
UCFL212D1	UCFL212	FL212	UC212G2	60	250	202	48	140	23	3,83
UELFL204-012D1W3	EXFL204-12	FL204	EX204-12G2	19,05	113	90	25,5	60	12	0,52
UELFL204D1W3	EXFL204	FL204	EX204G2	20	113	90	25,5	60	12	0,52
UELFL205-014D1W3	EXFL205-14	FL205	EX205-14G2	22,225	130	99	27	68	16	0,65
UELFL205-015D1W3	EXFL205-15	FL205	EX205-15G2	23,813	130	99	27	68	16	0,65
UELFL205-100D1W3	EXFL205-16	FL205	EX205-16G2	25,4	130	99	27	68	16	0,64
UELFL205D1W3	EXFL205	FL205	EX205G2	25	130	99	27	68	16	0,65
UELFL206-102D1W3	EXFL206-18	FL206	EX206-18G2	28,575	148	117	31	80	16	1,03

BU catalogue

2-Bolt flanged units

Remarks

Bearing inserts use different versions of set screws.

NTN bearing inserts: **UC200 / AS200:** ball point type
UEL200: cup point type (eccentric locking collar)

SNR bearing inserts: **UC200 / US200 / EX200:** knurled cup point type

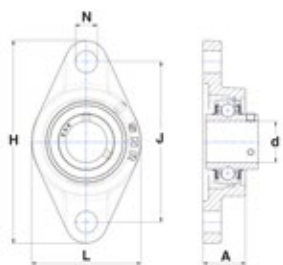

UCFL200

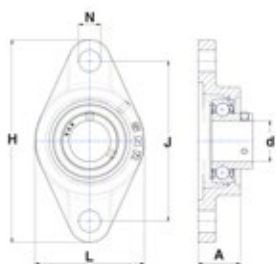

USFL200

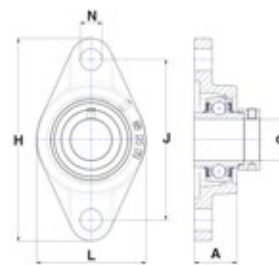

EXFL200

NTN corresponding part number	SNR BRAND									
	SNR part number Bearing Unit	SNR part number Housing	SNR part number Bearing	Bore diameter (d in mm)	Housing length (H in mm)	Mounting hole distance (J in mm)	Housing height (A in mm)	Housing width (L in mm)	Mounting bore Ø (N in mm)	Weight (kg)
UELFL206-103D1W3	EXFL206-19	FL206	EX206-19G2	30,163	148	117	31	80	16	1,00
UELFL206-104D1W3	EXFL206-20	FL206	EX206-20G2	31,75	148	117	31	80	16	0,98
UELFL206D1W3	EXFL206	FL206	EX206G2	30	148	117	31	80	16	1,01
UELFL207-104D1W3	EXFL207-20	FL207	EX207-20G2	31,75	161	130	34	90	16	1,36
UELFL207-105D1W3	EXFL207-21	FL207	EX207-21G2	33,338	161	130	34	90	16	1,34
UELFL207-106D1W3	EXFL207-22	FL207	EX207-22G2	34,925	161	130	34	90	16	1,31
UELFL207-107D1W3	EXFL207-23	FL207	EX207-23G2	36,513	161	130	34	90	16	1,28
UELFL207D1W3	EXFL207	FL207	EX207G2	35	161	130	34	90	16	1,30
UELFL208-108D1W3	EXFL208-24	FL208	EX208-24G2	38,1	175	144	36	100	16	1,73
UELFL208-109D1W3	EXFL208-25	FL208	EX208-25G2	39,688	175	144	36	100	16	1,72
UELFL208D1W3	EXFL208	FL208	EX208G2	40	175	144	36	100	16	1,68
UELFL209-110D1W3	EXFL209-26	FL209	EX209-26G2	41,275	188	148	38	108	19	2,16
UELFL209-111D1W3	EXFL209-27	FL209	EX209-27G2	42,863	188	148	38	108	19	2,11
UELFL209-112D1W3	EXFL209-28	FL209	EX209-28G2	44,45	188	148	38	108	19	2,07
UELFL209D1W3	EXFL209	FL209	EX209G2	45	188	148	38	108	19	2,07
UELFL210-114D1W3	EXFL210-30	FL210	EX210-30G2	47,625	197	157	40	115	19	2,50
UELFL210-115D1W3	EXFL210-31	FL210	EX210-31G2	49,213	197	157	40	115	19	2,44
UELFL210D1W3	EXFL210	FL210	EX210G2	50	197	157	40	115	19	2,41
UELFL211-200D1W3	EXFL211-32	FL211	EX211-32G2	50,8	224	184	43	130	19	3,48
UELFL211-202D1W3	EXFL211-34	FL211	EX211-34G2	53,975	224	184	43	130	19	3,28
UELFL211-203D1W3	EXFL211-35	FL211	EX211-35G2	55,563	224	184	43	130	19	3,26
UELFL211D1W3	EXFL211	FL211	EX211G2	55	224	184	43	130	19	3,29
UELFL212-204D1W3	EXFL212-36	FL212	EX212-36G2	57,15	250	202	48	140	23	4,33
UELFL212-206D1W3	EXFL212-38	FL212	EX212-38G2	60,325	250	202	48	140	23	4,10
UELFL212-207D1W3	EXFL212-39	FL212	EX212-39G2	61,913	250	202	48	140	23	4,06
UELFL212D1W3	EXFL212	FL212	EX212G2	60	250	202	48	140	23	4,17
ASFL204-012D1	USFL204-12	FL204	US204-12G2	19,05	113	90	25,5	60	12	0,43
ASFL204D1	USFL204	FL204	US204G2	20	113	90	25,5	60	12	0,43
ASFL205-014D1	USFL205-14	FL205	US205-14G2	22,225	130	99	27	68	16	0,58
ASFL205-015D1	USFL205-15	FL205	US205-15G2	23,813	130	99	27	68	16	0,58
ASFL205-100D1	USFL205-16	FL205	US205-16G2	25,4	130	99	27	68	16	0,56
ASFL205D1	USFL205	FL205	US205G2	25	130	99	27	68	16	0,57
ASFL206-102D1	USFL206-18	FL206	US206-18G2	28,575	148	117	31	80	16	0,88
ASFL206-103D1	USFL206-19	FL206	US206-19G2	30,163	148	117	31	80	16	0,85
ASFL206-104D1	USFL206-20	FL206	US206-20G2	31,75	148	117	31	80	16	0,84
ASFL206D1	USFL206	FL206	US206G2	30	148	117	31	80	16	0,87
ASFL207-106D1	USFL207-22	FL207	US207-22G2	34,925	161	130	34	90	16	1,08
ASFL207-107D1	USFL207-23	FL207	US207-23G2	36,513	161	130	34	90	16	1,07
ASFL207D1	USFL207	FL207	US207G2	35	161	130	34	90	16	1,12
ASFL208-108D1	USFL208-24	FL208	US208-24G2	38,1	175	144	36	100	16	1,50

NTN corresponding part number	SNR BRAND									
	SNR part number Bearing Unit	SNR part number Housing	SNR part number Bearing	Bore diameter (d in mm)	Housing length (H in mm)	Mounting hole distance (J in mm)	Housing height (A in mm)	Housing width (L in mm)	Mounting bore Ø (N in mm)	Weight (kg)
ASFL208D1	USFL208	FL208	US208G2	40	175	144	36	100	16	1,50
ASFL209-110D1	USFL209-26	FL209	US209-26G2	41,275	188	148	38	108	19	1,95
ASFL209-111D1	USFL209-27	FL209	US209-27G2	42,863	188	148	38	108	19	1,92
ASFL209-112D1	USFL209-28	FL209	US209-28G2	44,45	188	148	38	108	19	1,87
ASFL209D1	USFL209	FL209	US209G2	45	188	148	38	108	19	1,85
ASFL210-114D1	USFL210-30	FL210	US210-30G2	47,625	197	157	40	115	19	2,20
ASFL210-115D1	USFL210-31	FL210	US210-31G2	49,213	197	157	40	115	19	2,18
ASFL210D1	USFL210	FL210	US210G2	50	197	157	40	115	19	2,16
-	USFL211-32	FL211	US211-32G2	50,8	224	184	43	130	19	3,00
-	USFL211-35	FL211	US211-35G2	55,563	224	184	43	130	19	2,95
-	USFL211	FL211	US211G2	55	224	184	43	130	19	2,97
-	USFL212-36	FL212	US212-36G2	57,15	250	202	48	140	23	3,60
-	USFL212-39	FL212	US212-39G2	61,913	250	202	48	140	23	3,52
-	USFL212	FL212	US212G2	60	250	202	48	140	23	3,60

NTN

Make the world **NAMERAKA**



DOC_I_SNRPA_A_CAT2_GBa - Document non contractuel - NTN Europe copyright international - 12/24 - Photos : NTN Europe - Pedro Studio Photos, Shutterstock

This document is the exclusive property of NTN Europe. Any total or partial reproduction hereof without the prior consent of NTN Europe is strictly prohibited. Legal action may be brought against anyone breaching the terms of this paragraph.
NTN Europe shall not be held liable for any errors or omissions that may have crept into this document despite the care taken in drafting it. Due to our policy of continuous research and development, we reserve the right to make changes without notice to all or part of the products and specifications mentioned in this document.
© NTN Europe, international copyright 2024.

NTN Europe - 1 rue des Usines - 74000 Annecy
RCS ANNECY B 325 821 072 - Code APE 2815Z - Code NACE 28.15
www.ntn-europe.com



Brands of
NTN Group